

**HALO SERIES – ANTI-COLLISION LIGHT**



Model	Part No.	Voltage	Power (Watts)	Current (Amps)	Flash Rate	Wt (lbs)
Beacon/ACL RED-14VDC	AL-HS14ACL-1	12/14VDC	16.80	1.2A (peak)	50fpm	0.30
Beacon/ACL RED-28VDC	AL-HS28ACL-1	24/28VDC	35.0	1.25A (peak)		

*Not FAA-PMA approved; not intended for installation in certified aircraft*

**Installation Guide**

**Mounting Baseplate:** The baseplate may be used as drill guide template or reference the hole spacing in the mounting layout diagram (Ensure the arrow is facing forward). Drill the hole for the wire harness such that the size is adequate to pass the connector.

**Wiring:**

It is recommended to install a disconnect plug to aid in easy removal for inspection. Verify existing wiring & circuit interruption device is rated for the current demand in the table above (replace if necessary).

**Power Inputs:** Red wire: +12V(28V)

**Ground:** Black wire: to Battery Ground

**Mounting the light to baseplate:**

Place the light assy atop the baseplate and align the notch on light with the arrow in the baseplate. Apply BLUE thread locking compound (Loctite 242 or equivalent) to the three mounting screws. Loosely start all three set screws, being careful not to cross-thread. Once all three screws are started, snug each screw in rotation.

**Post-installation test:**

Test should be performed with either a GPU attached or with alternator online to ensure proper operational voltage. With beacon powered, test all radio & navigation equipment through the full frequency band to test for any adverse EMI/RFI. If applicable, recalibration of the magnetometer (refer to manufacturers published procedures) is required before return to service.

**Mounting Layout:**

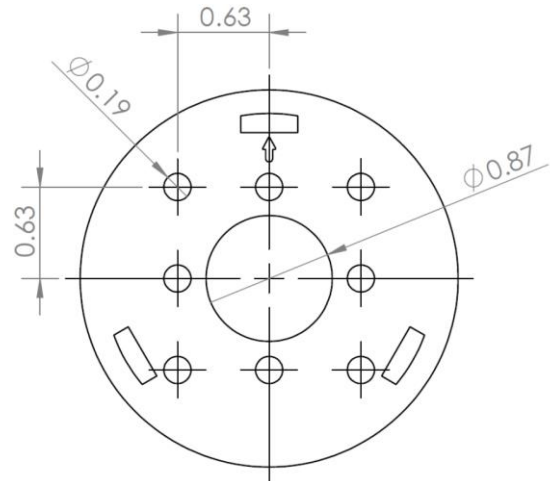

**Wiring Schematic:**

